

Hamilton Manufacturing Corporation

1026 Hamilton Dr. Holland, OH 43528 • Phone: 419-867-4858/800-837-5561 • Fax: 419-867-4857 • www.hamiltonmfg.com

HCS III Programming Manual

TABLE OF CONTENTS

HCS 3 OVERVIEW	5
HCS III WIRING SCHEMATIC	6
MULTIPLEXER	7
SYSTEM 3	8
HAND-HELD	9
LIST OF CHARACTERS	10
1-3 SHIFTS	11
Sell Code	11
1-3 SHIFTS	13
Fleet Code Prepay	13
1-3 SHIFTS	16
Fleet Code Credit	16
1-3 SHIFTS	18
Verify Code	18
MANAGER	20
Pricing and Taxes	20
MANAGER	22
Discounts	22
MANAGER	25
Taxes	25
MANAGER	26
Footer Message	26
Example	28
MANAGER	30
Pump Baud Rate	30
MANAGER	32
Pump Code Length	32
MANAGER	34
Validation Time	34
MANAGER	36
Password Setting	36
MANAGER	38
Fleet Accounts	38
MANAGER	40
Time	40
MANAGER	42
Period Reports	42
MANAGER	44
Fleet Reports	44
MANAGER	46
NR Counters	46
INSTALLER	48
Wash Package Names	48

Example	49
INSTALLER	51
Ticket Definition	51
INSTALLER	54
Output Value Definitions	54
INSTALLER	56
Factory Set-up	56
INSTALLER	57
Pos	57
INSTALLER	58
Ticket Address	58
Example	59
INSTALLER	62
Code Database	62
INSTALLER	65
Printer	65
INSTALLER	67
Reset Ticket #	67
INSTALLER	68
Date/Time	68
LIMITED WARRANTY AGREEMENT	70
OF HAMILTON MANUFACTURING CORP.	70

PREFACE

This manual is designed to guide you through the programming of your HCS III POS unit. Each menu screen is represented as a separate page. For further information, please contact Hamilton's Technical Support Department at (800) 837-5561.

HCS 3 OVERVIEW

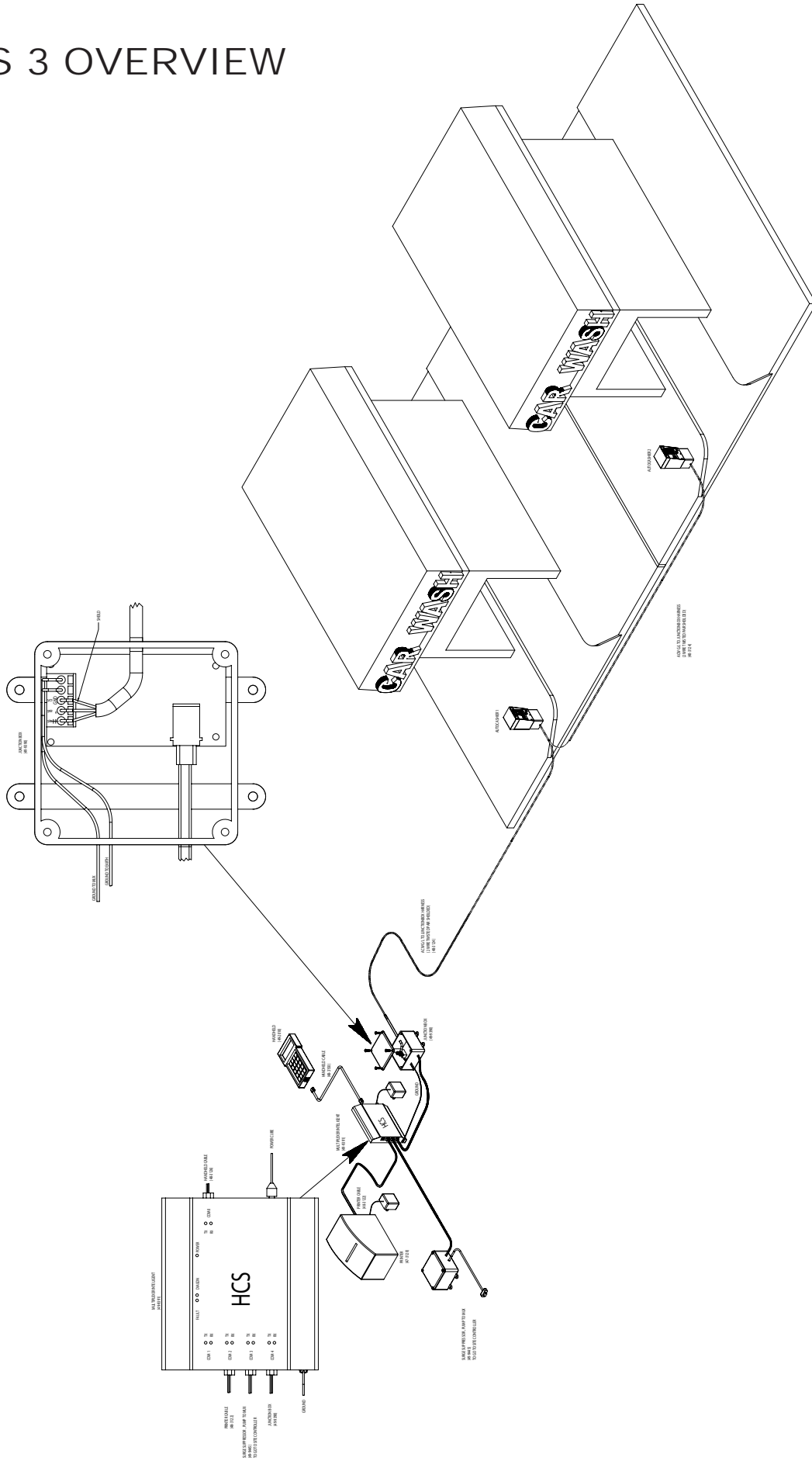

HCS III WIRING SCHEMATIC

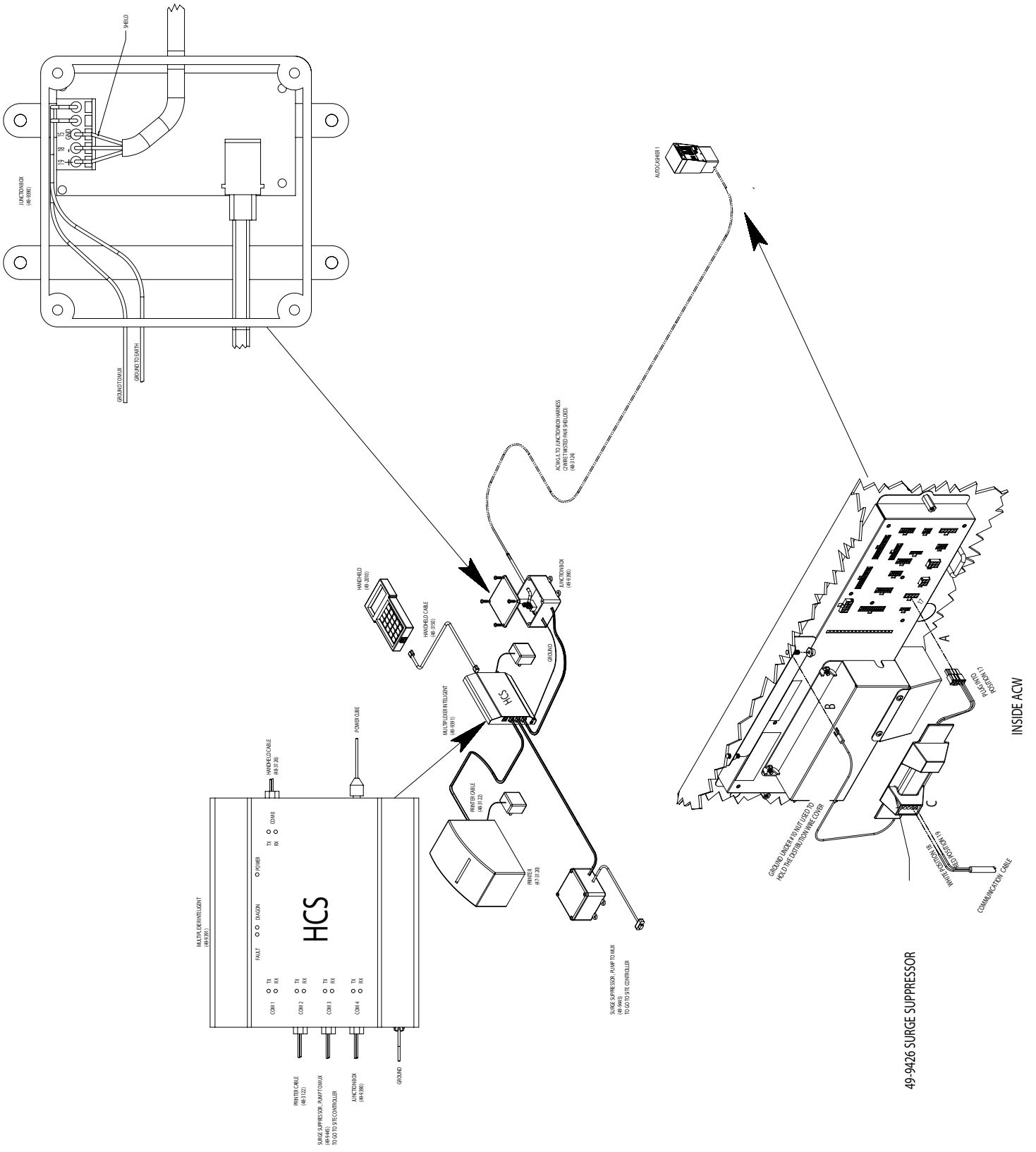

MULTIPLEXER

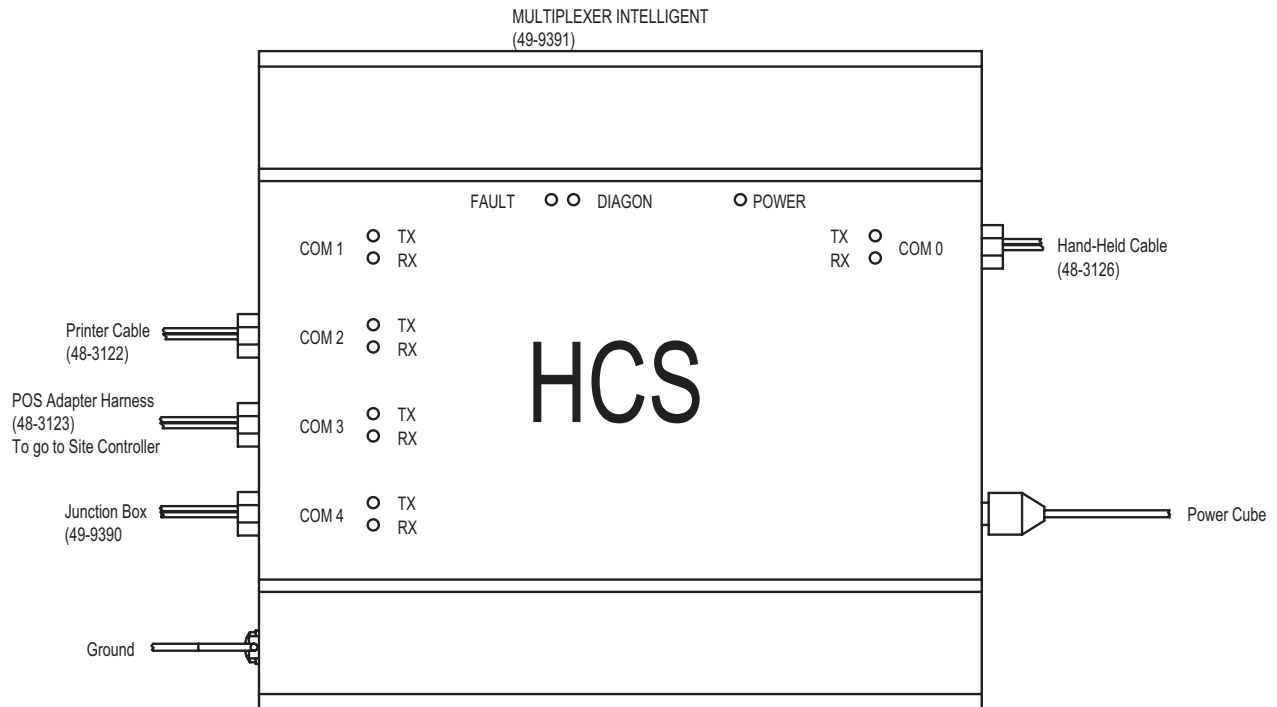

- The Hand-held will always be COM 0
- COM 1-4 **cannot** can be changed (Preset)
- COM 2 will be the printer
- COM 4 will be the Wash Interface

Wash Interface: The communication line between the Gold Line and the Wash Interface Box (Grey Box) is a 1 pair twisted shielded cable (White and Red). This communication line will run from the Wash Interface box to the Distribution panel in the Gold Line, where it will be plugged into the surge suppressor.

- **Very Important!** Whichever color you use in position #19 on your surge suppressor **MUST** match up to the positive "+" side in the wash interface box. The wire in position #18 on your surge suppressor **MUST** match up to the negative "-" side in the wash interface box.

SYSTEM 3

- Upon initial system power up the first screen will display:

***HAMILTON MFG
CODE SYSTEM WITH
GAS PUMP INTERFACE
SOFTWARE V X.XX***

- Next screen displays model and serial number.

***MODEL MUXCS
SERIAL NR. X***

- Next screen displays login in menu.

***LOGIN MENU
1-3 SHIFT
4= MANAGER
5= INSTALLER***

- You will be inputting from both the “F” function keys and numerical keys.

LIST OF CHARACTERS

A a _	G g &	M m ,	S s 2	Y y 8
B b !	H h ‘	N n -	T t 3	Z z 9
C c “	I I (O o .	U u 4	[{ :
D d #	J j)	P p /	V v 5	; \
E e \$	K k *	Q q 0	W w 6	<] }
F f %	L l +	R r 1	X x 7	

- The _ in box 1 signifies a blank spot.

1-3 SHIFTS

SELL CODE

LOGIN MENU

1-3 SHIFTS

4 = MANAGER

5 = INSTALLER

- To proceed into the 1-3 shift press either 1, 2 or 3.
- Next screen displays:

F1 = SELL CODES

F2 = FLEET

F3 = VERIFY CODES

- To proceed into Sell codes press the F1 key.
- Next screen will display your wash names:

F1 = WASH

F2 = WASH & WAX

F3 = WASH & WAX & DRY

F4 = SUPER WASH

- By pressing an “F” function button you are selecting the wash package.
- By pressing any “F” function button the screen will automatically change.
- Next screen displays:

SELECT PRICE GROUP

F1 = FULL PRICE

F2 = WITH DISCOUNT

F3 = FREE / REWASH

- By pressing an “F” function button you are selecting the pricing package.
- By pressing an “F” function button the screen will automatically change.
- The code that is generated will display.

- Next screen displays:

F1 = WASH
F2 = WASH & WAX
F3 = WASH & WAX & DRY
F4 = SUPER WASH

- This procedure works for shifts 1, 2 and 3.
- To generate another code follow the above steps.

1-3 SHIFTS

*FLEET CODE
PREPAY*

*LOGIN MENU
1-3 SHIFTS
4 = MANAGER
5 = INSTALLER*

- To proceed into the 1-3 shift press either 1, 2 or 3.
- Next screen displays:

*F1 = SELL CODES
F2 = FLEET
F3 = VERIFY CODES*

- To proceed into Fleet press the F2 key.
- If you are not accepting fleet codes, the next screen displays:

NOT AUTHORIZED

- If you are accepting fleet codes, the next screen displays:

*F1 = WASH
F2 = WASH & WAX
F3 = WASH & WAX & DRY
F4 = SUPER WASH*

- Press F1-F4 for a wash package.
- Next screen displays:

F1 = PREPAY F2 = CREDIT

- If prepay is required press F1 key.
- Next screen displays:

PRICE/WASH _ _ _ _

- Enter the amount of the wash by pressing the numbers on the keypad in cents.

- Pressing the right arrow ⇒ will change the screen automatically. The next screen displays:

QUANTITY _ _ _ _

- This will allow you to enter the number of washes based on the dollar amount.
- Enter the number of washes. If number is less than 3 digits, press the right arrow ⇒ .
- Next screen displays:

MULTIPLE CODES

Y = YES

N = NO

- Pressing “Y” will display code and allow multiple codes.
- Pressing “N” will display code and will not allow multiple codes.
- Next screen displays:

CODE SELECTION

F1 = SELECT OWN CODE

F2 = COMPUTER PICKED

MAKE SELECTION

- By pressing F1 you will be able to select your own code.
- Next screen displays:

CODE SELECTION

ENTER YOUR CODE

- Enter a 4 digit number.
- Once you enter that number, it will print out and become valid.
- Next screen displays:

F1 = WASH

F2 = WASH & WAX

F3 = WASH & WAX & DRY

F4 = SUPER WASH

- If you want the computer to select your code press F2.
- The code will automatically print out and it will be valid.
- Next screen displays:

F1 = WASH
F2 = WASH & WAX
F3 = WASH & WAX & DRY
F4 = SUPER WASH

1-3 SHIFTS

*FLEET CODE
CREDIT*

*LOGIN MENU
1-3 SHIFTS
4 = MANAGER
5 = INSTALLER*

- To proceed into the 1-3 shift press either 1, 2 or 3.
- Next screen displays:

*F1 = SELL CODES
F2 = FLEET
F3 = VERIFY CODES*

- To proceed into Fleet press the F2 key.
- If you are not accepting fleet codes, the next screen displays:

NOT AUTHORIZED

- If you are accepting fleet codes, the next screen displays:

*F1 = WASH
F2 = WASH & WAX
F3 = WASH & WAX & DRY
F4 = SUPER WASH*

- Press F1-F4 for a wash package.
- Next screen displays:

F1 = PREPAY F2 = CREDIT

- If credit is required, press F2 key.

- Next screen displays:

***CODE SELECTION
F1 = SELECT OWN CODE
F2 = COMPUTER PICKED
MAKE SELECTION***

- Press F1 to select your own code.
- Next screen displays:

***CODE SELECTION
ENTER YOUR CODE....***

- Enter a four digit number.
- When the number is entered it will print out and be valid.
- Next screen displays:

***F1 = WASH
F2 = WASH & WAX
F3 = WASH & WAX & DRY
F4 = SUPER WASH***

- If you want the computer to select the code, press F2.
- The code will automatically print out and be valid.
- Next screen displays:

***F1 = WASH
F2 = WASH & WAX
F3 = WASH & WAX & DRY
F4 = SUPER WASH***

1-3 SHIFTS

VERIFY CODE

LOGIN MENU
1-3 SHIFTS
4 = MANAGER
5 = INSTALLER

- To proceed into the 1-3 Shift press 1, 2 or 3.
- Next screen displays:

F1 = SELL CODES
F2 = FLEET
F3 = VERIFY CODES

- To proceed into Verify Codes press F3.
- Next screen displays:

ENTER CODE _ _ _ _ _

- Enter the five digit code using the numbers on the keypad.
- When the last number is entered the screen will automatically change.
- If the code is invalid, the next screen displays:

CODE IS EXPIRED

- If the code is valid, the next screen displays:

F1 = DELETE CODE
F4 = EXIT

- This will allow you to delete the code or exit the screen.
- If you delete a code and try to re-verify it, it will shown as used.

- If the code has been used, the next screen displays:

USED ISSUED DAY

- If the code you are verifying is a fleet code, the following will be displayed:

DEBIT X #0

F1 = DELETE CODE

F4 = EXIT

- Pressing the F1 key will allow you to start the code.
- Pressing the F2 key will allow you to delete the code.
- Pressing either F1 or F2 will automatically change the screen:

F1 = SELL CODES

F2 = FLEET

F3 = VERIFY CODES

MANAGER

PRICING AND TAXES

LOGIN MENU

1-3 SHIFTS

4 = MANAGER

5 = INSTALLER

- To proceed into the Manager set up press the # 4.
- The next screen will prompt you for a Password. Enter 1234.
- Next screen displays:

F1 = PRICING AND TAXES

F2 = GENERAL SETTINGS

F3 = TIME

F4 = REPORTS

- To proceed into the Pricing and Taxes press the F1 key.
- Next screen displays:

F1 = PACKAGE PRICING

F2 = DISCOUNTS

F3 = TAXES

- To proceed into the Package Pricing press the F1 key.
- Next screen displays:

SELECT OPTION .

- This selection allows up to four pricing packages.
- Pressing 1-4 will display the screen for the correct wash.
- Press number 1.

- Next screen displays:

WASH NAME (TEXT) \$0.00

F1=ACCEPT

F2=MODIFY

- Wash name will appear to the left of screen and wash price will to the right.
- If wash price is correct then press the F1 key.
- If F1 is pressed, the next screen displays:

SELECT OPTION.

- If wash price is incorrect then press the F2 key.
- Next screen displays:

WASH NAME _ _ _ _ _

PRESS ⇐ TO CORRECT

PRESS ⇒ TO ACCEPT

- To enter the price, use the numbers on the keypad and enter the amount in cents. (Example: 100=\$1.00)
- If entered incorrectly, use the left arrow key to correct.
- Use the right arrow key to accept the amount.
- Pressing the right arrow key automatically changes the screen:

SELECT OPTION

- To program pricing 2-4 if applicable, press the appropriate number and repeat the steps above.

MANAGER

DISCOUNTS

LOGIN MENU

1-3 SHIFTS

4 = MANAGER

5 = INSTALLER

- To proceed into the Manager set up press the #4.
- The next screen will prompt you for a password. Enter 1234.
- Next screen displays:

F1 = PRICING AND TAXES

F2 = GENERAL SETTINGS

F3 = TIME

F4 = REPORTS

- To proceed into the Pricing and Taxes, press the F1 key.
- Next screen displays:

F1 = PACKAGE PRICING

F2 = DISCOUNTS

F3 = TAXES

- To proceed into the Discount selection press the F2 key.
- Next screen displays:

DISCOUNT 2-3

- This will allow you set up discount levels 2 and 3.
- Press #2.
- Next screen displays:

DISCOUNT 2 \$0.00

F1 = ACCEPT

F2 = MODIFY

- If discount 2 price is correct then press the F1 key.
- If F1 key is pressed, the next screen will display:

DISCOUNT 2-3

- If discount 2 price is incorrect then press the F2 key.
- Next screen displays:

DISCOUNT 2 _ _ _ _ _

***PRESS ⇐ TO CORRECT
PRESS ⇒ TO ACCEPT***

- To enter the amount of discount, use the numbers on the keypad to enter the amount in cents. (Example 200 = \$2.00)
- If entered incorrectly use the left arrow to correct.
- To accept the amount use the right arrow.
- Pressing the right arrow will automatically change the screen:

DISCOUNT 2-3

- This will allow you set up discount levels 2 and 3.
- Press number 3.
- Next screen displays:

DISCOUNT 3 \$0.00

***F1 = ACCEPT
F2 = MODIFY***

- If discount 3 price is correct then press the F1 key.
- If F1 key is pressed, the next screen displays:

DISCOUNT 2-3

- If discount 3 price is incorrect then press the F2 key.
- Next screen displays:

DISCOUNT 3 _ _ _ _ _

PRESS ⇐ TO CORRECT

PRESS ⇒ TO ACCEPT

- To enter the amount of discount, use the numbers on the keypad and enter the amount in cents.
(Example 200 = \$2.00)
- Entering 999 will force a free wash.
- To correct an entry use the left arrow key.
- To accept the amount use the right arrow.
- Pressing the right arrow will automatically change the screen:

DISCOUNT 2-3

MANAGER

TAXES

LOGIN MENU

1-3 SHIFTS

4 = MANAGER

5 = INSTALLER

- To proceed into the Manager set up press the # 4.
- The next screen will prompt you for a password. Enter 1234.
- Next screen displays:

F1 = PRICING AND TAXES

F2 = GENERAL SETTINGS

F3 = TIME

F4 = REPORTS

- To proceed into the Pricing and Taxes press the F1 key.
- Next screen displays:

F1 = PACKAGE PRICING

F2 = DISCOUNTS

F3 = TAXES

- To proceed into the Taxes selection press the F3 key.
- Next screen displays:

TAX DEFINITION

F1 = TAX RATE 1

F2 = TAX RATE 2

* That the rest of this application is only applicable to the car wash owner.

MANAGER

FOOTER MESSAGE

LOGIN MENU
1-3 SHIFTS
4 = MANAGER
5 = INSTALLER

- To proceed into the Manager set up press the # 4.
- The next screen will prompt you for a password. Enter 1234.
- Next screen displays:

F1 = PRICING AND TAXES
F2 = GENERAL SETTINGS
F3 = TIME
F4 = REPORTS

- To proceed into General Settings press the F2 key.
- Next screen displays:

F1 = MORE SETTINGS
F2 = VALIDATION TIME
F3 = PASSWORD SETTING
F4 = FLEET ACCOUNTS

- To proceed in to More Settings press F1.
- Next screen displays:

F1 = FOOTER MESSAGE
F2 = PUMP BAUD RATE
F3 = PUMP CODE LENGTH

- To proceed into the Footer Message press the F1 key.

- Next screen displays:

F1 = ACCEPT
F2 = MODIFY

- Footer message allows up to two lines of printed text at the bottom of the receipt.
- If message is correct press the F1 key.
- If F1 is pressed, the next screen displays:

F1 = ACCEPT
F2 = MODIFY

- If the message is incorrect press F2.
- Next screen displays:

F1 = ENTER TEXT MODE
F2 = UPPER/LOWER/SPEC.
F3 = SCROLL-UP F4 = DOWN

- Next screen displays:

F1 = MORE SETTINGS
F2 = VALIDATION TIME
F3 = PASSWORD SETTING
F4 = FLEET ACCOUNTS

EXAMPLE

Press F1 an "A" will appear in first spot

A _ _ _ _ _

Using the F2 button will allow you to scroll from upper case to lower case to spec.

Using the F3 button will allow you to scroll up the alphabet.

Using the F4 button will allow you to scroll down the alphabet.

Press the F3 button to desired letter or digit or symbol

G _ _ _ _ _

Next by pressing the F1 button will place an "A" in the next space

GA _ _ _ _ _

Using the F2 button will allow you to scroll from upper case to lower case to spec.

Using the F3 button will allow you to scroll up the alphabet.

Using the F4 button will allow you to scroll down the alphabet.

Using the F1 button will allow you to move to the next space.

Next by pressing the F1 button will place an "A" in the next space

GOA _ _ _ _ _

Using the F2 button will allow you to scroll from upper case to lower case to spec.

Using the F3 button will allow you to scroll up the alphabet.

Using the F4 button will allow you to scroll down the alphabet.

Using the F1 button will allow you to move to the next space.

Next by pressing the F1 button will place an "A" in the next space.

GOOA _ _ _ _ _

Using the F2 button will allow you to scroll from upper case to lower case to spec.

Using the F3 button will allow you to scroll up the alphabet.

Using the F4 button will allow you to scroll down the alphabet.

Using the F1 button will allow you to move to the next space.

Next by pressing the F1 button will place an "A" in the next space

GOOD A _ _ _ _ _

Using the F2 button will allow you to scroll from upper case to lower case to spec.

Using the F3 button will allow you to scroll up the alphabet.

Using the F4 button will allow you to scroll down the alphabet.

Using the F1 button will allow you to move to the next space.

Next by pressing the F1 button will place an “A” in the next space
GOOD DA_ _ _ _ _

Using the F2 button will allow you to scroll from upper case to lower case to spec.
Using the F3 button will allow you to scroll up the alphabet.
Using the F4 button will allow you to scroll down the alphabet.
Using the F1 button will allow you to move to the next space.

Next by pressing the F1 button will place an “A” in the next space.
GOOD DAA _ _ _ _ _

Using the F2 button will allow you to scroll from upper case to lower case to spec.
Using the F3 button will allow you to scroll up the alphabet.
Using the F4 button will allow you to scroll down the alphabet.
Using the F1 button will allow you to move to the next space.

After using an “F” Function key your screen should display
GOOD DAY_ _ _ _ _

- By pressing the F1 key it will automatically go to next line.

MANAGER

PUMP BAUD RATE

LOGIN MENU
1-3 SHIFTS
4 = MANAGER
5 = INSTALLER

- To proceed into the Manager set up press the # 4.
- The next screen will prompt you for a password. Enter 1234.
- Next screen displays:

F1 = PRICING AND TAXES
F2 = GENERAL SETTINGS
F3 = TIME
F4 = REPORTS

- To proceed into General Settings press the F2 key.
- Next screen displays:

F1 = MORE SETTINGS
F2 = VALIDATION TIME
F3 = PASSWORD SETTING
F4 = FLEET ACCOUNTS

- To proceed in to More Settings press F1.
- Next screen displays:

F1 = FOOTER MESSAGE
F2 = PUMP BAUD RATE
F3 = PUMP CODE LENGTH

- To proceed into Pump Baud Rate press F2.
- Next screen displays:

F1 = 9600 BAUD
F2 = 19200 BAUD

- Pressing either F1 or F2 will choose the baud rate that you use to talk to the site controller. You will need to know which one is appropriate for your site.

Pressing F1 or F2 will automatically advance you to the next screen.

Next screen displays:

F1 = FOOTER MESSAGE
F2 = PUMP BAUD RATE
F3 = PUMP CODE LENGTH

MANAGER

PUMP CODE LENGTH

LOGIN MENU

1-3 SHIFTS

4 = MANAGER

5 = INSTALLER

- To proceed into the Manager set up press the # 4.
- The next screen will prompt you for a password. Enter 1234.
- Next screen displays:

F1 = PRICING AND TAXES

F2 = GENERAL SETTINGS

F3 = TIME

F4 = REPORTS

- To proceed into General Settings press the F2 key.
- Next screen displays:

F1 = MORE SETTINGS

F2 = VALIDATION TIME

F3 = PASSWORD SETTING

F4 = FLEET ACCOUNTS

- To proceed in to More Settings press F1.
- Next screen displays:

F1 = FOOTER MESSAGE

F2 = PUMP BAUD RATE

F3 = PUMP CODE LENGTH

- To proceed into Pump Code Length press F3.
- Next screen displays:

F1 = 5 DIGIT CODE

F2 = 6 DIGIT CODE

- Pressing either F1 or F2 will choose the code length that will be generated at the cash register and gas pumps. You will need to match this with the code length that you set in your Gold Line Autocashier.
- Pressing either F1 or F2 will automatically advance you to the next screen.
- Next screen displays:

F1 = FOOTER MESSAGE

F2 = PUMP BAUD RATE

F3 = PUMP CODE LENGTH

MANAGER

VALIDATION TIME

LOGIN MENU
1-3 SHIFTS
4 = MANAGER
5 = INSTALLER

- To proceed into the Manager set up press the # 4.
- The next screen will prompt you for a password. Enter 1234.
- Next screen displays:

F1 = PRICING AND TAXES
F2 = GENERAL SETTINGS
F3 = TIME
F4 = REPORTS

- To proceed into General Settings press the F2 key.
- Next screen displays:

F1 = MORE SETTINGS
F2 = VALIDATION TIME
F3 = PASSWORD SETTING
F4 = FLEET ACCOUNTS

- To proceed into the Validation Time press the F2 key.
- Next screen displays:

VALID _ _ DAYS

F1 = ACCEPT
F2 = MODIFY

- Validation time is the length of time a code is valid. This time can be up to 254 days.
- If the length of time is correct press F1.

- Next screen displays:

***F1 = MORE SETTINGS
F2 = VALIDATION TIME
F3 = PASSWORD SETTING
F4 = FLEET ACCOUNTS***

- If the length of time is incorrect press F2.
- Next screen displays:

***VALID _ _ _ _ DAYS

PRESS ⇐ TO CORRECT
PRESS ⇒ TO ACCEPT***

- To enter length of time, press the numbers on the keypad. (Example 30)
- To correct an entry, use the left arrow key.
- To accept the length of time use the right arrow.
- Pressing the right arrow will automatically change the screen:

***F1 = MORE SETTINGS
F2 = VALIDATION TIME
F3 = PASSWORD SETTING
F4 = FLEET ACCOUNTS***

MANAGER

PASSWORD SETTING

LOGIN MENU

1-3 SHIFTS

4 = MANAGER

5 = INSTALLER

- To proceed into the Manager set up press the # 4.
- The next screen will prompt you for a password. Enter 1234.
- Next screen displays:

F1 = PRICING AND TAXES

F2 = GENERAL SETTINGS

F3 = TIME

F4 = REPORTS

- To proceed into General Settings press the F2 key.
- Next screen displays:

F1 = MORE SETTINGS

F2 = VALIDATION TIME

F3 = PASSWORD SETTING

F4 = FLEET ACCOUNTS

- To proceed into Password Setting press the F3 key
- Next screen displays:

F1 = SHIFT 1

F2 = SHIFT 2

F3 = SHIFT 3

F4 = MANAGER

- Password settings allows you to set individual passwords for your shifts and manager.
- By pressing F1 it will allow you to set Shift one password.
- Next screen displays:

PASSWORD 0

F1 = ACCEPT
F2 = MODIFY

- If password is correct press the F1 key.
- Next screen displays:

F1 = SHIFT 1
F2 = SHIFT 2
F3 = SHIFT 3
F4 = MANAGER

- If password is incorrect press the F2 key.
- Next screen displays:

PASSWORD _ _ _ _ _

PRESS ⇐ TO CORRECT
PRESS ⇒ TO ACCEPT

- To enter the password, press the numbers on the keypad. (Example 2457)
- To correct an entry, use the left arrow key.
- To accept the password use the right arrow.
- Pressing the right arrow will automatically change the screen.
- Next screen displays:

F1 = SHIFT 1
F2 = SHIFT 2
F3 = SHIFT 3
F4 = MANAGER

- To program passwords for shifts 2-3 and manager, press the appropriate number and follow the above steps.

MANAGER

FLEET ACCOUNTS

LOGIN MENU

1-3 SHIFTS

4 = MANAGER

5 = INSTALLER

- To proceed into the Manager set up press the # 4.
- The next screen will prompt you for a password. Enter 1234.
- Next screen displays:

F1 = PRICING AND TAXES

F2 = GENERAL SETTINGS

F3 = TIME

F4 = REPORTS

- To proceed into General Settings press the F2 key.
- Next screen displays:

F1 = MORE SETTINGS

F2 = VALIDATION TIME

F3 = PASSWORD SETTING

F4 = FLEET ACCOUNTS

- To proceed into the Fleet Accounts press the F4 key.
- Next screen displays:

F1 = ALLOW FLEET CODES

F2 = NO FLEET CODES

- Fleet Accounts allows you to accept fleet codes or not use fleet codes.
- Pressing F1 will allow you to use fleet codes.

- Next screen displays:

F1 = MORE SETTINGS
F2 = VALIDATION TIME
F3 = PASSWORD SETTING
F4 = FLEET ACCOUNTS

- By pressing F2 it will not allow the use of fleet codes.
- Next screen displays:

F1 = MORE SETTINGS
F2 = VALIDATION TIME
F3 = PASSWORD SETTING
F4 = FLEET ACCOUNTS

MANAGER

TIME

LOGIN MENU

1-3 SHIFTS

4 = MANAGER

5 = INSTALLER

- To proceed into the Manager set up press the # 4.
- The next screen will prompt you for a password. Enter 1234.
- Next screen displays:

F1 = PRICING AND TAXES

F2 = GENERAL SETTINGS

F3 = TIME

F4 = REPORTS

- To proceed into the Time press the F3 key.
- Next screen displays:

F1 = DISPLAY CLOCK

F2 = CHANGE TIME

- To proceed into the Display clock press F1.
- This screen allows you to see the date and time.
- Next screen displays:

CLOCK SETTING

DATE: 10/14/02

TIME: 16:16

- By pressing F2 it will allow you to change the time.
- Next screen displays:

ENTER TIME __ / __

- To enter the time, use the numbers on the keypad.
- Once the last number is entered, it automatically changes the screen.
- Next screen displays:

F1 = DISPLAY CLOCK
F2 = CHANGE TIME

MANAGER

PERIOD REPORTS

LOGIN MENU

1-3 SHIFTS

4 = MANAGER

5 = INSTALLER

- To proceed into the Manager set up press the # 4.
- The next screen will prompt you for a password. Enter 1234.
- Next screen displays:

F1 = PRICING AND TAXES

F2 = GENERAL SETTINGS

F3 = TIME

F4 = REPORTS

- To proceed into Reports press the F4 key.
- Next screen displays:

F1 = PERIOD REPORT

F2 = FLEET REPORT

F3 = NR COUNTERS

- To proceed into Period Report press F1 key.
- Next screen displays:

FR MMDD __ / __

- Period report will allow you to input a starting date and an ending date and display the activity during that period.
- To enter the month and date, use the numbers on the keypad.
- Once the last number is entered it will automatically change the screen.
- Next screen displays:

TO MMDD __ / __

- To enter the ending dating, use the numbers on the keypad
- Once the last number is entered it automatically changes the screen.
- Next screen displays:

PRINTING REPORT

- Next screen displays:

REPORT COPY

Y = YES

N = NO

- This allows you to print another copy of the report.
- If “Y” is pressed another copy is printed.
- If “N” is pressed it changes the screen automatically.
- Next screen displays:

F1 = PRICING AND TAXES

F2 = GENERAL SETTINGS

F3 = TIME

F4 = REPORTS

MANAGER

FLEET REPORTS

LOGIN MENU

1-3 SHIFTS

4 = MANAGER

5 = INSTALLER

- To proceed into the Manager set up press the # 4.
- The next screen will prompt you for a password. Enter 1234.
- Next screen displays:

F1 = PRICING AND TAXES

F2 = GENERAL SETTINGS

F3 = TIME

F4 = REPORTS

- To proceed into Reports press the F4 key.
- Next screen displays:

F1 = PERIOD REPORT

F2 = FLEET REPORT

F3 = NR COUNTERS

- To proceed into fleet report press F2 key.
- Next screen displays:

F1 = PRINT ALL FLEET

F2 = PRINT USED ONLY

- Pressing F1 allows you to print all of your issued fleet codes.
- Pressing F2 allows you to print only the fleet codes that have been used.
- Note: This is both Prepay and Fleet codes.
- By pressing either F1 or F2 the screen will automatically change.

- Next screen displays:

PRINTING REPORT

- Screen automatically changes.
- Next screen displays:

REPORT COPY ?

Y = YES

N = NO

- Pressing “Y” will print another copy of the report.
- Pressing “N” will not print another copy of the report. The screen will change automatically.
- Next screen displays:

F1 = CLEAR POSTPAY

- Pressing F1 will clear Postpay.
- Pressing any other key will not clear Postpay and will automatically change the screen.
- Next screen displays:

F1 = PRICING AND TAXES

F2 = GENERAL SETTINGS

F3 = TIME

F4 = REPORTS

MANAGER

NR COUNTERS

LOGIN MENU

1-3 SHIFTS

4 = MANAGER

5 = INSTALLER

- To proceed into the Manager set up press the # 4.
- The next screen will prompt you for a password. Enter 1234.
- Next screen displays:

F1 = PRICING AND TAXES

F2 = GENERAL SETTINGS

F3 = TIME

F4 = REPORTS

- To proceed into Reports press the F4 key.
- Next screen displays:

F1 = PERIOD REPORT

F2 = FLEET REPORT

F3 = NR COUNTERS

- To proceed into NR Counters press F3 key. NR = Non-Resetables.
- Next screen displays:

TOTAL COUNTERS

SOLD ⇔ 14

WASHED ⇔ 1

- Pressing any key on the keypad will automatically change the screen.

- Next screen displays:

F1 = PRICING AND TAXES

F2 = GENERAL SETTINGS

F3 = TIME

F4 = REPORTS

INSTALLER

WASH PACKAGE NAMES

LOGIN MENU

1-3 SHIFTS

4 = MANAGER

5 = INSTALLER

- To proceed into the Installer set up press the # 5.
- The next screen will prompt you for a password. Enter 0108.
- Next screen displays:

F1 = CAR WASH SET UP

F2 = POS

F3 = DATABASE FUNCTION

F4 = DATE/TIME

- To proceed into the Car Wash Set up press the F1 key.
- Next screen displays:

F1 = WASH PACKAGES NAMES

F2 = TICKET DEFINITION

F3 = OUT PUT VALUE DEF.

F4 = FACTORY SET UP

- To proceed into the Wash packages Names press the F1 key.
- Next screen displays:

GIVE OPTION 1-8

- This option allows up to 8 wash package names.
- If this is a new start up, a wash name will need to be added. If a wash name is already selected you can change it.
- To proceed into the next screen press the 1 key.

- Next screen displays:

(BLANK)
F1 = ACCEPT
F2 = MODIFY

- If correct wash name appears press F1.
- If screen is blank press F2.
- Next screen displays:

F1 = ENTER TEXT MODE
F2 = UPPER/LOWER/SPEC.
F3 = SCROLL-UP F4 = DOWN

EXAMPLE

Press F1 an "A" will appear in first spot

A _____

Using the F2 button will allow you to scroll from upper case to lower case to spec.

Using the F3 button will allow you to scroll up the alphabet.

Using the F4 button will allow you to scroll down the alphabet.

Press the F3 button to desired letter or digit or symbol

W _____

Next by pressing the F1 button will place an "A" in the next space

WA _____

Using the F2 button will allow you to scroll from upper case to lower case to spec.

Using the F3 button will allow you to scroll up the alphabet.

Using the F4 button will allow you to scroll down the alphabet.

Using the F1 button will allow you to move to the next space.

Next by pressing the F1 button will place an "A" in the next space

WAA _____

Using the F2 button will allow you to scroll from upper case to lower case to spec.

Using the F3 button will allow you to scroll up the alphabet.

Using the F4 button will allow you to scroll down the alphabet.

Using the F1 button will allow you to move to the next space.

Next by pressing the F1 button will place an "A" in the next space.

WASA _____

Using the F2 button will allow you to scroll from upper case to lower case to spec.

Using the F3 button will allow you to scroll up the alphabet.
Using the F4 button will allow you to scroll down the alphabet.
Using the F1 button will allow you to move to the next space.

After using an "F" Function key your screen should display
WASH _ _ _ _ _

If this is the desired wash name press the right arrow ⇒ to accept the choice.

If more text is needed continue with,

Using the F2 button will allow you to scroll from upper case to lower case to spec.
Using the F3 button will allow you to scroll up the alphabet.
Using the F4 button will allow you to scroll down the alphabet.
Using the F1 button will allow you to move to the next space.

- If the ⇒ is pressed the next screen will display:

GIVE OPTION 1-8

- To program washes 2-8 if applicable, press the appropriate number and follow the above steps.

INSTALLER

TICKET DEFINITION

LOGIN MENU

1-3 SHIFTS

4 = MANAGER

5 = INSTALLER

- To proceed into the Installer set up press the # 5.
- The next screen will prompt you for a password. Enter 0108.
- Next screen displays:

F1 = CAR WASH SET UP

F2 = POS

F3 = DATABASE FUNCTION

F4 = DATE/TIME

- To proceed into the Car Wash Set up press the F1 key.
- Next screen displays:

F1 = WASH PACKAGES NAMES

F2 = TICKET DEFINITION

F3 = OUT PUT VALUE DEF.

F4 = FACTORY SET UP

- To proceed into the Ticket Definition press the F2 key.
- Next screen displays:

GIVE OPTION 1-8

- This option allows you to define the wash name to the wash package.
- To proceed into the next screen press the 1 key.

- Next screen displays:

TICKET 1 DEF 1

F1 = ACCEPT

F2 = MODIFY

- Ticket 1 = 1, Ticket 2 = 2, Ticket 3 = 4, Ticket 4 = 8, Ticket 5 = 16, Ticket 6 = 32, Ticket 7 = 64, and Ticket 8 = 128
- If correct Definition appears press F1 Accept.
- If Definition is incorrect press F2 Modify.
- Pressing F1 changes the screen to display:

GIVE OPTION 1-8

- Press the appropriate number and follow the above steps.
- Pressing F2 changes the screen to display:

TICKET 1 DEF _ _ _

PRESS ⇐ TO CORRECT

PRESS ⇒ TO ACCEPT

- Press the appropriate numerical key to match the ticket number.
- Then press the right arrow ⇒ to accept.
- If wrong number was entered, press the left arrow ⇐ and input the correct number.
- If ⇒ is pressed the next screen displays:

GIVE PROGRAM 1-8

- Pressing the left arrow changes the screen automatically:

NO DISC MSK 0

F1 = ACCEPT

F2 = MODIFY

- This allows you to program a wash package to not have a discount.

- If you want all of your washes packages to have a discount, leave the value at 0.
- Press F1 to accept.
- Next screen displays:

***F1 = WASH PACKAGES NAMES
F2 = TICKET DEFINITION
F3 = OUT PUT VALUE DEF.
F4 = FACTORY SET UP***

- By pressing F2 to modify, the next screen displays:

NO DISC MSK _ _ _ _ _

***PRESS ⇐ TO CORRECT
PRESS ⇒ TO ACCEPT***

- Enter number 1-4 to define the wash package you do not want to allow a discount for.
- Press the appropriate numerical key to match the ticket number.
- Then press the right arrow ⇒ to accept.
- If wrong number was entered, press the left arrow ⇐ and input the correct number.
- If ⇒ is pressed the next screen displays.

***F1 = WASH PACKAGES NAMES
F2 = TICKET DEFINITION
F3 = OUT PUT VALUE DEF.
F4 = FACTORY SET UP***

- To Program Ticket Definition 2-8 if applicable, press the appropriate number and follow the above steps.

INSTALLER

OUTPUT VALUE DEFINITIONS

LOGIN MENU

1-3 SHIFTS

4 = MANAGER

5 = INSTALLER

- To proceed into the Installer set up press the # 5.
- The next screen will prompt you for a password. Enter 0108.
- Next screen displays:

F1 = CAR WASH SET UP

F2 = POS

F3 = DATABASE FUNCTION

F4 = DATE/TIME

- To proceed into the Car Wash Set up press the F1 key.
- Next screen displays:

F1 = WASH PACKAGES NAMES

F2 = TICKET DEFINITION

F3 = OUTPUT VALUE DEF.

F4 = FACTORY SET UP

- To proceed into Output Value Def. Press the F3 key.
- Next screen displays:

GIVE OPTION 1-8

- This option allows you to match the relay with the wash package.
- To proceed into the next screen press the 1 key.

- Next screen displays:

PRGR 1 DEF 1

F1 = ACCEPT

F2 = MODIFY

- Prgr 1 = 1, Prgr 2 = 2, Prgr 3 = 3 and Prgr 4 = 4
- If correct Definition appears press the F1 Accept.
- If Definition is incorrect press F2 Modify.
- Pressing F1 screen displays:

GIVE OPTION 1-8

- Press the appropriate number and follow the above steps.
- If F2 to modify is pressed the screen displays:

PRGR 1 DEF _ _ _

PRESS ⇐ TO CORRECT

PRESS ⇒ TO ACCEPT

- Press the appropriate numerical key to match the Program number.
- Then press the right arrow ⇒ to accept.
- If wrong number was entered, press the left arrow ⇐ and re-input the correct number.
- If ⇒ is pressed the next screen displays:

GIVE PROGRAM 1-8

- To program Output Value Def 2-8 if applicable press the appropriate number and follow the above steps.

INSTALLER

FACTORY SET-UP

LOGIN MENU

1-3 SHIFTS

4 = MANAGER

5 = INSTALLER

- To proceed into the Installer set up press the # 5.
- The next screen will prompt you for a password. Enter 0108.
- Next screen displays:

F1 = CAR WASH SET UP

F2 = POS

F3 = DATABASE FUNCTION

F4 = DATE/TIME

- To proceed into the Car Wash Set up press the F1 key.
- Next screen displays:

F1 = WASH PACKAGES NAMES

F2 = TICKET DEFINITION

F3 = OUT PUT VALUE DEF.

F4 = FACTORY SET

- F4 is for **FACTORY ONLY** (Default settings from Kesseltronics)

INSTALLER

POS

LOGIN MENU

1-3 SHIFTS

4 = MANAGER

5 = INSTALLER

- To proceed into the Installer set up press the # 5.
- The next screen will prompt you for a password. Enter 0108.
- Next screen displays:

F1 = CAR WASH SET UP

F2 = POS

F3 = DATABASE FUNCTION

F4 = DATE/TIME

- To proceed into the Pos press the F2 key.
- Next screen displays:

CREATE A SEPARATE

PUMP SALES REPORT?

Y = YES

N = NO

- Pressing “Y” will give you a pump sales report and display the next screen.
- Pressing “N” will not give you a pump sales report and will display the next screen:

F1 = CAR WASH SET UP

F2 = POS

F3 = DATABASE FUNCTION

F4 = DATE/TIME

INSTALLER

TICKET ADDRESS

LOGIN MENU
1-3 SHIFTS
4 = MANAGER
5 = INSTALLER

- To proceed into the Installer set up press the # 5.
- The next screen will prompt you for a password. Enter 0108.
- Next screen displays:

F1 = CAR WASH SET UP
F2 = POS
F3 = DATABASE FUNCTION
F4 = DATE/TIME

- To proceed into the Database Function press the F3 key.
- Next screen displays:

F1 = TICKET ADDRESS
F2 = CODE DATABASE
F3 = PRINTER
F4 = RESET TICKET #

- To proceed into the Ticket Address press the F1 key.
- Next screen displays:

SELECT ITEM 1-6

- This will give you up to 6 lines to input an address if applicable.
- To proceed into the next screen press the 1 key.

- If this is a new start up, information will need to be entered. If the information is already selected you can change it.

(BLANK)
F1 = ACCEPT
F2 = MODIFY

- If correct information appears press F1.
- If screen is blank press F2.
- Pressing F1 displays:

SELECT ITEM 1-6

- Pressing F2 displays:

F1 = ENTER TEXT CODE
F2 = UPPER/LOWER/SPEC.
F3 = SCROLL-UP F4 = DOWN

EXAMPLE

Press F1 an "A" will appear in the first spot

A _____

Using the F2 button will allow you to scroll from Upper case to Lower case to Spec.

Using the F3 button will allow you to scroll up the alphabet

Using the F4 button will allow you to scroll down the alphabet.

Press the F3 button to desired letter or digit or symbol

W _____

Next by pressing the F1 button will place an "A" in the next space

WA _____

Using the F2 button will allow you to scroll from Upper case to Lower case to Spec.

Using the F3 button will allow you to scroll up the alphabet

Using the F4 button will allow you to scroll down the alphabet.

Using the F1 button will allow you to move to the next space

Next by pressing the F1 button will place an "A" in the next space

WEA _____

Using the F2 button will allow you to scroll from Upper case to Lower case to Spec.

Using the F3 button will allow you to scroll up the alphabet
Using the F4 button will allow you to scroll down the alphabet.
Using the F1 button will allow you to move to the next space

Next by pressing the F1 button will place an “A” in the next space

WELA _ _ _ _ _

Using the F2 button will allow you to scroll from Upper case to Lower case to Spec.
Using the F3 button will allow you to scroll up the alphabet
Using the F4 button will allow you to scroll down the alphabet.
Using the F1 button will allow you to move to the next space

Next by pressing the F1 button will place an “A” in the next space

WELCA _ _ _ _ _

Using the F2 button will allow you to scroll from Upper case to Lower case to Spec.
Using the F3 button will allow you to scroll up the alphabet
Using the F4 button will allow you to scroll down the alphabet.
Using the F1 button will allow you to move to the next space

Next by pressing the F1 button will place an “A” in the next space

WELCOA _ _ _ _ _

Using the F2 button will allow you to scroll from Upper case to Lower case to Spec.
Using the F3 button will allow you to scroll up the alphabet
Using the F4 button will allow you to scroll down the alphabet.
Using the F1 button will allow you to move to the next space

Next by pressing the F1 button will place an “A” in the next space

WELCOMA _ _ _ _ _

Using the F2 button will allow you to scroll from Upper case to Lower case to Spec.
Using the F3 button will allow you to scroll up the alphabet
Using the F4 button will allow you to scroll down the alphabet.
Using the F1 button will allow you to move to the next space

After using an “F” function key your screen should display

WELCOME _ _ _ _ _

If this is the desired text press the right arrow ⇒ to accept the choice
If more text is needed continue with,

Using the F2 button will allow you to scroll from Upper case to Lower case to Spec.

Using the F3 button will allow you to scroll up the alphabet
Using the F4 button will allow you to scroll down the alphabet.
Using the F1 button will allow you to move to the next space

- If the right arrow _ is pressed the next screen will display:

SELECT ITEM 1-6

- To program ticket address 2-6 if applicable press the appropriate number and follow the above steps.

INSTALLER

CODE DATABASE

LOGIN MENU

1-3 SHIFTS

4 = MANAGER

5 = INSTALLER

- To proceed into the Installer set up press the # 5.
- The next screen will prompt you for a password. Enter 0108.
- Next screen displays:

F1 = CAR WASH SET UP

F2 = POS

F3 = DATABASE FUNCTION

F4 = DATE/TIME

- To proceed into the Database Function press the F3 key.
- Next screen displays:

F1 = TICKET ADDRESS

F2 = CODE DATABASE

F3 = PRINTER

F4 = RESET TICKET #

- To proceed into the Code Database press the F2 key.
- Next screen displays:

F1 = SELECT FIXED CODE

F2 = CLEAR CODE BASE

- Pressing F1 allows you to input a four digit code. **Installer use only for testing.**
- Pressing F2 allows you to clear the code database.

- Pressing F1 displays:

FIXED CODE 0

F1 = ACCEPT

F2 = MODIFY

- If correct code appears press F1.
- If code needs to be changed press F2 to Modify.
- If F2 is pressed, the screen displays:

FIXED CODE _ _ _ _ _

PRESS ⇐ TO CORRECT

PRESS ⇒ TO ACCEPT

- Press the appropriate numerical keys to desired code.
- Then press the right arrow ⇒ to Accept.
- If wrong number is entered, press the left arrow ⇐ and input the correct number.
- If ⇒ is pressed the next screen displays:

REPORT FX CD F1 = Y

Y = YES

N = NO

- Pressing “Y” will report the fixed code and display the next screen.
- Pressing “N” will not report the fixed code and display the next screen:

F1 = CAR WASH SET UP

F2 = POS

F3 = DATABASE FUNCTION

F4 = DATE/TIME

- To proceed into the Database Function press the F3 key.

- Next screen displays:

F1 = TICKET ADDRESS
F2 = CODE DATABASE
F3 = PRINTER
F4 = RESET TICKET #

- To proceed into the Code Database press the F2 key.
- Next screen displays:

F1 = SELECT FIXED CODE
F2 = CLEAR CODE BASE

- Pressing F2 will allow you to clear the database.
- Pressing F2 displays:

F1 = ERASE ALL CODES
F2 = ALL CODES VALID

- If F1 is pressed all codes are erased.
- If F2 is pressed all codes are valid.

CAUTION!! By pressing F2 **it will erase all codes** and make any five digit number a valid code, so when trying to issue a code through your sell screen it will not display a code because they are already valid.

- If F1 is pressed the next screen displays:

ERASING CODES

- If F2 is pressed the next screen displays:

ERASING CODES

- After either Erasing Codes next screen displays:

F1 = CAR WASH SET UP
F2 = POS
F3 = DATABASE FUNCTION
F4 = DATE/TIME

INSTALLER

PRINTER

LOGIN MENU

1-3 SHIFTS

4 = MANAGER

5 = INSTALLER

- To proceed into the Installer set up press the # 5.
- The next screen will prompt you for a password. Enter 0108.
- Next screen displays:

F1 = CAR WASH SET UP

F2 = POS

F3 = DATABASE FUNCTION

F4 = DATE/TIME

- To proceed into the Database Function press the F3 key.
- Next screen displays:

F1 = TICKET ADDRESS

F2 = CODE DATABASE

F3 = PRINTER

F4 = RESET TICKET #

- To proceed into the Printer press the F3 key.
- Next screen displays:

F1 = STAR EMUL. (9600)

F2 = EPSON T88 (19,200)

F3 = SP-200 B&W (9600)

F4 = DO NOT CHANGE

- **The only one** that should be selected is F2 Epson T88 (19,200).

- Next screen displays:

F1 = CAR WASH SET UP
F2 = POS
F3 = DATABASE FUNCTION
F4 = DATE/TIME

INSTALLER

RESET TICKET #

***LOGIN MENU
1-3 SHIFTS
4 = MANAGER
5 = INSTALLER***

- To proceed into the Installer set up press the # 5.
- The next screen will prompt you for a password. Enter 0108.
- Next screen displays:

***F1 = CAR WASH SET UP
F2 = POS
F3 = DATABASE FUNCTION
F4 = DATE/TIME***

- To proceed into the Database Function press the F3 key.
- Next screen displays:

***F1 = TICKET ADDRESS
F2 = CODE DATABASE
F3 = PRINTER
F4 = RESET TICKET #***

- To proceed into the Reset Ticket # press the F4 key.
- Pressing F4 automatically resets the ticket number.
- Next screen displays:

***F1 = CAR WASH SET UP
F2 = POS
F3 = DATABASE FUNCTION
F4 = DATE/TIME***

INSTALLER

DATE/TIME

LOGIN MENU

1-3 SHIFTS

4 = MANAGER

5 = INSTALLER

- To proceed into the Installer set up press the # 5.
- The next screen will prompt you for a password. Enter 0108.
- Next screen displays:

F1 = CAR WASH SET UP

F2 = POS

F3 = DATABASE FUNCTION

F4 = DATE/TIME

- To proceed into the Date/Time press the F4 key.
- Next screen displays:

F1 = DISPLAY CLOCK

F2 = CHANGE TIME

F3 = CHANGE DATE

- To proceed into Display Clock press F1.
- Next screen displays:

CLOCK SETTINGS

DATE: 10/11/02

TIME: 12:14

- Pressing any ‘F’ function key will automatically change the display.
- Next screen displays:

F1 = DISPLAY CLOCK

F2 = CHANGE TIME

F3 = CHANGE DATE

- To proceed into the Change Time press F2 key.
- Next screen displays:

Enter time __ : __

- To enter in the time press the appropriate number on the hand-held.
- When entering the last number it will automatically change the display.
- Next screen displays:

F1 = DISPLAY CLOCK
F2 = CHANGE TIME
F3 = CHANGE DATE

- To proceed into Change Date press the F3 key.
- Next screen displays:

MMDDYY __/__/__

- To enter the correct date press the appropriate number on the hand-held.
- When entering the last number it will automatically change the display.
- Next screen displays:

F1 = DISPLAY CLOCK
F2 = CHANGE TIME
F3 = CHANGE DATE

LIMITED WARRANTY AGREEMENT OF HAMILTON MANUFACTURING CORP.

Hamilton Manufacturing Corp., an Ohio Corporation, (“Seller”) warrants to Purchaser that all new equipment shall be free from defects in material and factory workmanship for a period of one (1) year from the original shipping date. Hamilton Manufacturing Corp. further warrants if any part of said new equipment in Seller’s sole opinion, requires replacement or repair due to a defect in material or factory workmanship during said period, Seller will repair or replace said new equipment. Purchaser’s remedies and the liabilities and obligations of Seller herein shall be limited to repair or replacement of the equipment as Seller may choose, and Seller’s obligation to remedy such defects shall not exceed the Purchaser’s original cost for the equipment. Purchaser EXPRESSLY AGREES this is the EXCLUSIVE REMEDY under this warranty. There are no other express or implied warranties which extend beyond the face hereof. All warranty repair service must be performed by either a Factory Trained Service Representative or **HAMILTON MANUFACTURING CORP., 1026 Hamilton Drive, Holland, Ohio 43528 PHONE (419) 867-4858 or (800) 837-5561, FAX (419) 867-4867.**

The limited warranty for new equipment is conditioned upon the following:

1. The subject equipment has not, in the Seller’s sole opinion, been subjected to: accident, abuse, misuse, vandalism, civil disobedience, riots, acts of God, natural disaster, acts of war or terrorism.
2. The Seller shall not be liable for any expense incurred by Purchaser incidental to the repair or replacement of equipment and Purchaser shall assume full responsibility for any freight or shipping charges.
3. The coverage of this warranty shall not extend to expendable parts.
4. Purchaser shall have a warranty registration card on file with Seller prior to any claim in order for warranty protection to apply.
5. No warranty coverage is applicable to any equipment used for currency other than that specified at the time of the purchase.
6. Seller expressly disclaims any warranty that counterfeit currency will not activate said equipment.
7. Seller expressly disclaims any warranty for any losses due to bill manipulation or theft or loss of cash under any circumstances.
8. Use of the equipment for anything other than its intended and designed use will void the Limited Warranty Agreement. Use of equipment for anything other than its intended and designed use includes, but is not limited to, downloading software/applications not certified by Seller such as e-mail, spyware, screen savers, viruses, worms, third party software, web search engines, cookies, spam, desktop applications, games, web surfing, etc.

Seller further warrants all repair or service work performed by a factory trained representative or Hamilton Manufacturing Corp. for a period of ninety (90) days from the date the repair or service work was performed. Purchaser’s remedies and the liabilities and obligations of Seller herein shall be limited to repair or replacement of equipment as Seller may choose, and Seller’s obligation to remedy such defects shall not exceed the Purchaser’s depreciated value of the equipment. Purchaser EXPRESSLY AGREES this is an EXCLUSIVE REMEDY under this warranty. There are no other express or implied warranties on repair or service work performed by a factory trained representative or Hamilton Manufacturing Corp. which extend beyond the face hereof.

The limited warranty for repair and service work is conditioned upon the following:

1. The subject equipment has not, in the Seller's sole opinion, been subjected to: accident, abuse, misuse, vandalism, civil disobedience, riots, acts of God, natural disaster, acts of war or terrorism.
2. The Seller shall not be liable for any expense incurred by Purchaser incidental to the repair or replacement of equipment and Purchaser shall assume full responsibility for any freight or shipping charges.
3. The coverage of this warranty shall not extend to expendable parts.
4. Purchaser shall have a warranty registration card on file with Seller prior to any claim in order for warranty protection to apply.
5. No warranty coverage is applicable to any equipment used for currency other than that specified at the time of the purchase.
6. Seller expressly disclaims any warranty that counterfeit currency will not activate said equipment.
7. Seller expressly disclaims any warranty for any losses due to bill manipulation or theft or loss of cash under any circumstances.
8. No person or entity other than a factory trained representative or Hamilton Manufacturing Corp. has performed or attempted to perform the subject repair or service.
9. Using equipment which has been serviced or repaired for anything other than its intended or designed use such as downloading software applications not certified by Seller will void the Limited Warranty Agreement. This includes software/applications such as e-mail, spyware, screen savers, viruses, worms, third party software, web search engines, cookies, spam, desktop applications, games, web surfing, etc.

THIS AGREEMENT IS MADE WITH THE EXPRESS UNDERSTANDING THAT THERE ARE NO IMPLIED WARRANTIES THAT THE EQUIPMENT SHALL BE MERCHANTABLE, OR THAT THE GOODS SHALL BE FIT FOR ANY PARTICULAR PURPOSE. PURCHASER HEREBY ACKNOWLEDGES THAT IT IS NOT RELYING ON THE SELLER'S SKILL OR JUDGMENT TO SELECT OR FURNISH EQUIPMENT SUITABLE FOR ANY PARTICULAR PURPOSE AND THAT THERE ARE NO WARRANTIES WHICH EXTEND BEYOND THAT WHICH IS DESCRIBED HEREIN.

The Purchaser agrees that in no event will the Seller be liable for direct, indirect, or consequential damages or for injury resulting from any defective or non-conforming new, repaired or serviced equipment, or for any loss, damage or expense of any kind, including loss of profits, business interruption, loss of business information or other pecuniary loss arising in connection with this Limited Warranty Agreement, or with the use of, or inability to use the subject equipment regardless of Sellers knowledge of the possibility of the same.

Hamilton Manufacturing Corporation

1026 Hamilton Drive
Holland, OH 43528

Sales Phone: (888) 723-4858 **Sales Fax:** (419) 867-4850
Customer Service Phone: (800) 837-5561 **Customer Service Fax:** (419) 867-4857
Parts Phone: (866) 835-1721 **Parts Fax:** (419) 867-4867

Website: <http://www.hamiltonmfg.com>

Email Addresses:

service@hamiltonmfg.com

sales@hamiltonmfg.com

parts@hamiltonmfg.com

info@hamiltonmfg.com