

# ER-60 COINCO RETROFIT KIT #100-0050

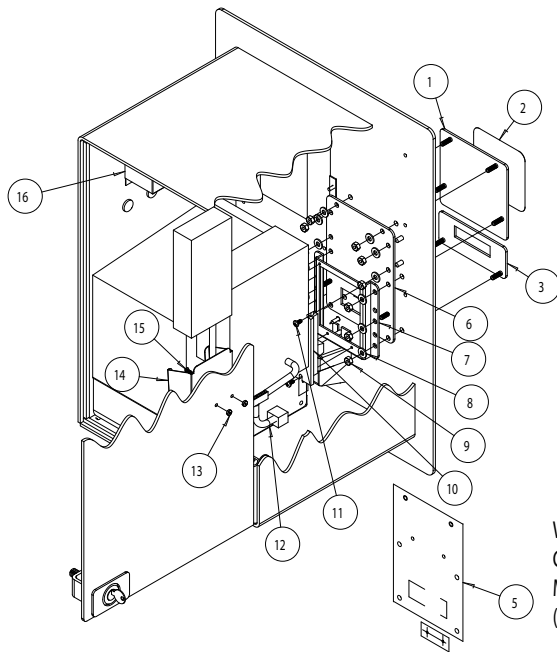

NOTE--  
1.0 IF THE CONTROLLER IS NOT A C2000  
MODEL IT WILL HAVE TO BE REPLACED  
WITH PRT# 49-2000A

WILL WORK ONLY WITH  
COINCO  
MODEL # MAG50BAB  
(NOT PROVIDED)

| ITEM# | PART#    | DESCRIPTION                          | QTY. |
|-------|----------|--------------------------------------|------|
| 16    | 103-0003 | EPROM, PROGRAM C2000 v2.0            | 1    |
| 15    | 90-0129  | SCREW, #6-32 x 3/8                   | 2    |
| 14    | 60-2057  | POWER PACK HOLDER                    | 1    |
| 13    | 90-0308  | NUT, #6-32                           | 2    |
| 12    | 48-3011  | HARNES, M-LINE, COINCO ADAPTOR       | 1    |
| 11    | 90-0144  | SCREW, #8-32 x 5/8                   | 4    |
| 10    | 46-0168  | VALIDATOR, COINCO (120V)             |      |
| 9     | 90-0331  | NUT, #1/4-20                         | 12   |
| 8     | 90-0403  | WASHER, #1/4 INTERNAL LOCK           | 12   |
| 7     | 60-2051  | U-CHANNEL                            | 1    |
| 6     | 60-0383  | RETROFIT, BACK PLATE                 | 1    |
| 5     | 96-2050  | TEMPLATE, RETROFIT, ER-60            | 1    |
| 4     | 101-0026 | INTRUCTIONS, RETROFIT, ER-60, COINCO | 1    |
| 3     | 60-2200  | FACE PLATE, RETROFIT, ER-60          | 1    |
| 2     | 96-0173  | RETROFIT DOLLAR DECAL SET            | 1    |
| 1     | 60-2201  | COVER PLATE, RETROFIT, ER-60         | 1    |

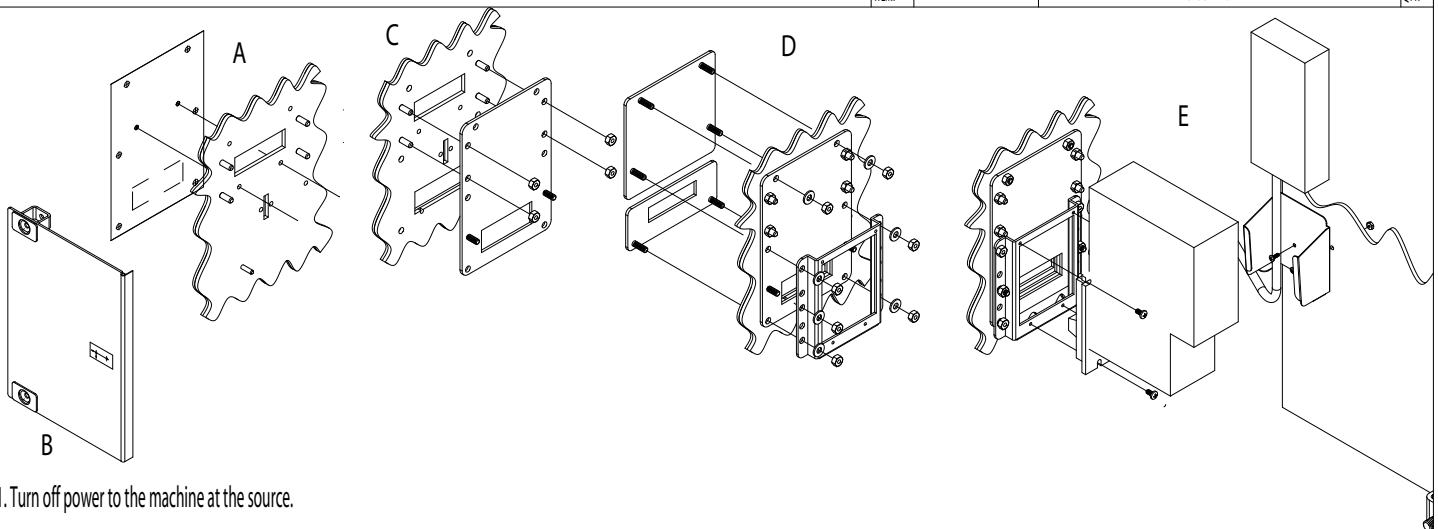

1. Turn off power to the machine at the source.
2. Remove validator, controller, stacker, stacker brackets, power box and harness from the machine. Be sure to then plug in the stacker bypass plug.
3. Remove ball studs and validator face plate.
4. Align template with the bottom two face plate mounting holes on the face of the machine.(A)
5. Mark and drill the six mounting holes (marked "A") through the face of the cabinet and the lexan, using a 3/8" bit.
6. Mark and cut validator opening in both the cabinet and lexan.
7. Position door template as specified, mark and drill 2 holes using a 3/16" bit.(B)
8. Mount back plate using the top 4 validator mounting studs. (C)
9. Mount the face plate, cover plate and u-channel through the lexan, cabinet face, and the back plate and tighten. (D)
10. Mount the power pack holder on the back door of the cabinet.
11. Attach the validator to the U-channel using #8-32 x 1/2 screws. (E)
12. Confirm C2000 controller eprom is v2.0 or later, if not replace with enclosed eprom. Replace components in machine.
13. Add validator harness adaptor to the validator harness and plug into the validator power pack.
14. Attach the wanted dollar decal to the front of the face plate.
15. Turn on the power to the machine.